

# Selecting a BIAR Sample System

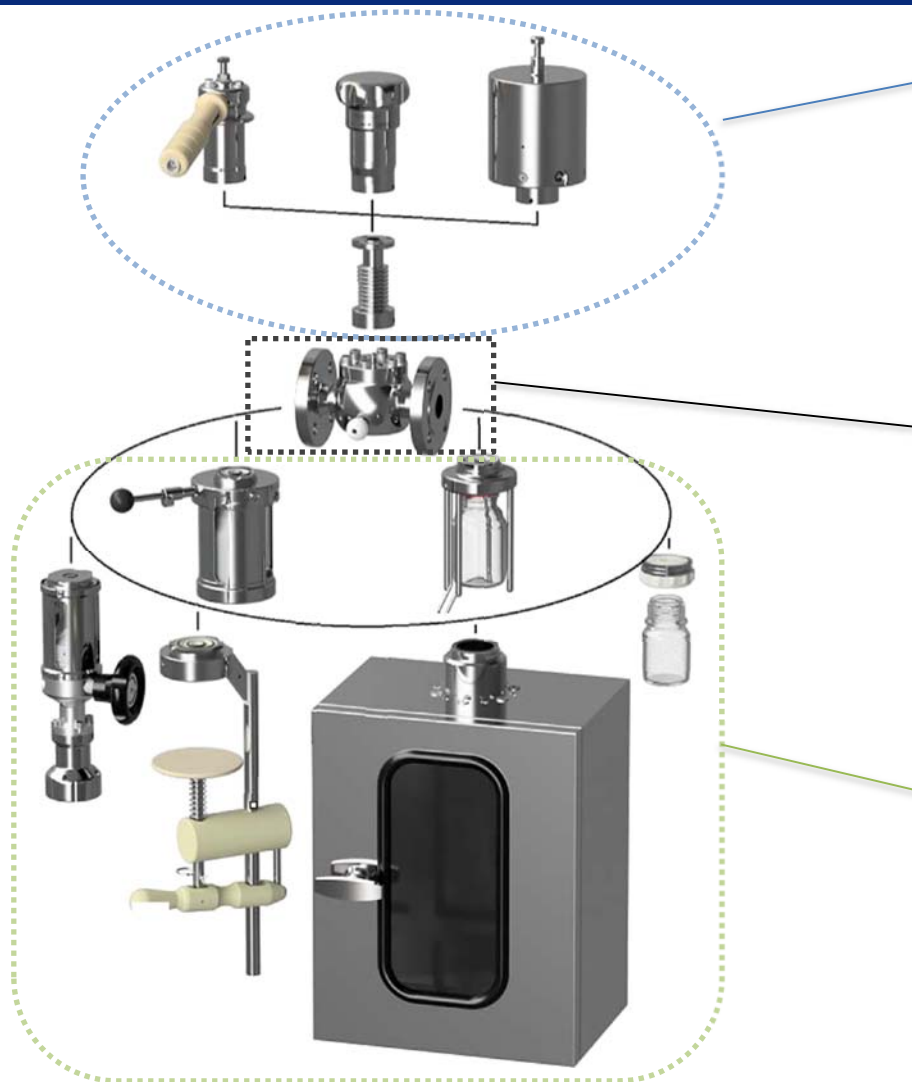

**Drive:** How to operate the valve

**Valve body:** material of construction, size and class compatible with P&ID

**Accessories** - Most distinctive part of a sample valve: How to collect the sample. Two main categories to choose from: **open-top receptacles** such as bottles and jar and **sample cylinders** for liquefied gas and volatile chemicals